

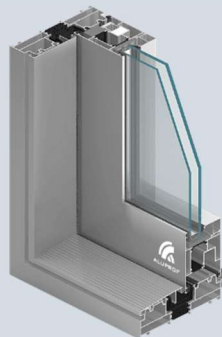

Hansen



## Sliding Door Aluprof MB-77HS

The door **MB-77HS** provides excellent weather tightness together with enhanced thermal performance, complies with all of the requirements associated with this product type. Available in two different options, with regard to the level of thermal performance, the door is further categorised as “ST” and “HI,” standard or highly insulated. The design & arrangement of the system profiles enable luxurious openings of large dimensions, accommodating double & even triple glass unit compositions, which in conjunction with the constituent parts & innovative technical solutions, help achieve a high level of thermal & acoustic performance.

<b>Design:</b>	The slender and durable profile makes it possible to build a low-threshold door weighing up to 600 kg, with a height of up to 3.2 m and a width of up to 3.3 m. The frames are available in twin-track and triple-track variants.
<b>Air permeability:</b>	class 4, EN 12207
<b>Water tightness:</b>	class 9A, EN 12208
<b>Wind load classification:</b>	to class C4, EN 12210

- 90° and 270° corners can be built, creating an exceptionally large space once the door is open
- a slender, 47 mm mullion
- convenient solutions featuring a low threshold
- a wide range of infills, including the use of single- or double-glazed units, as well as thermal breaks, a range of accessories and insulating inserts making it possible to achieve excellent thermal and acoustic parameters
- three styles of glazing beads: Standard, which is rectangular; Prestige, which is rounded; and Style, which is diamond shaped
- the MB-77HS features a high level of compatibility with the ALUPROF MB-86 allowing the door to can be aesthetically combined with windows and some of the same parts can be used to build them

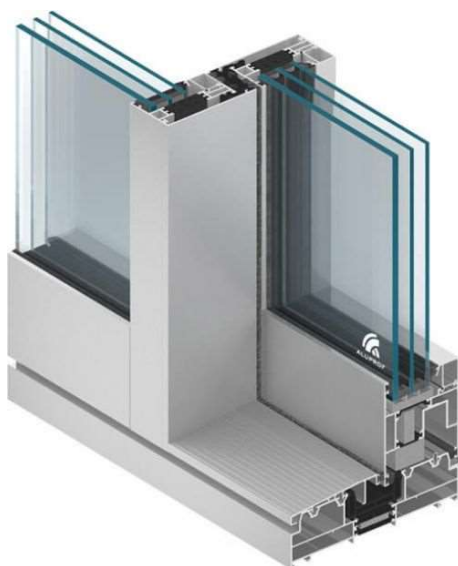

### Standard parameters of leaves for GU fittings

<b>Leaf profile</b>	K518808X K518809X	K518810X K518811X
<b>Weight</b>	max 200kg	max 300kg (400kg*)
<b>Length Ls</b>	700-2200mm	720-3300mm
<b>Heigh Hs</b>	1841-2741mm	1843-2743mm

\* - with additional carriages

### Standard parameters of leaves for HAUTAU fittings

<b>Leaf profile</b>	K518808X K518809X		K518810X K518811X
<b>Weight</b>	max 120kg	max 200kg	max 330kg
<b>Length Ls</b>	650-2360mm	650-2360mm	755-3255mm
<b>Heigh Hs</b>	1291-2491mm	1291-2791mm	1307-2807mm

Recommended Hs:  $Ls \leq 3: 1$

## Technical specification

<b>Frame depth</b>	174mm (2-rail profile), 271mm (3-rail profile)
<b>Casement depth</b>	77mm
<b>Glazing thickness</b>	13,5-61mm
<b>Minimum width of frame</b>	48mm
<b>Minimum width of sash</b>	94.5 – 105.5 mm
<b>Maximum dimensions</b>	$H_s=3,24\text{m}$ , $L_s=3,3\text{m}$
<b>Thermal insulation</b>	$U_f$ from 1,4 W/m <sup>2</sup> K, $U_w$ from 0,84 W/m <sup>2</sup> K*

\* -  $U_w$  for MB-77HS HI doors with 3000x2900mm leaf and glazing of  $U_g=0,5$  W/m<sup>2</sup>K equipped with a Chromatech Ultra spacer.

## Available door construction

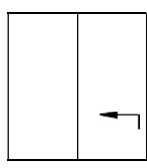

Scheme A

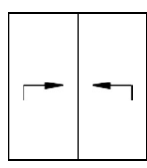

Scheme D

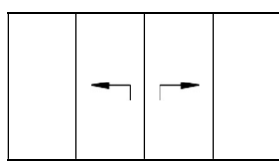

Scheme C

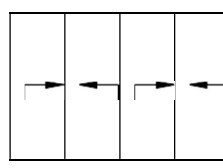

Scheme F

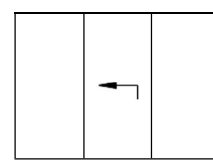

Scheme G2

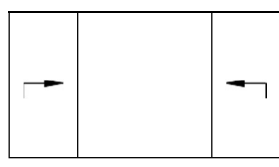

Scheme K

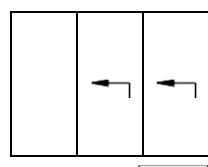

Scheme A+G

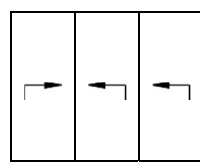

Scheme D+G

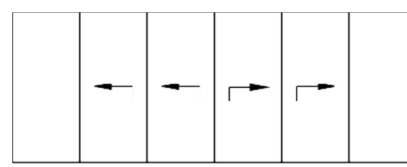

Scheme C+D+G

## Solutions

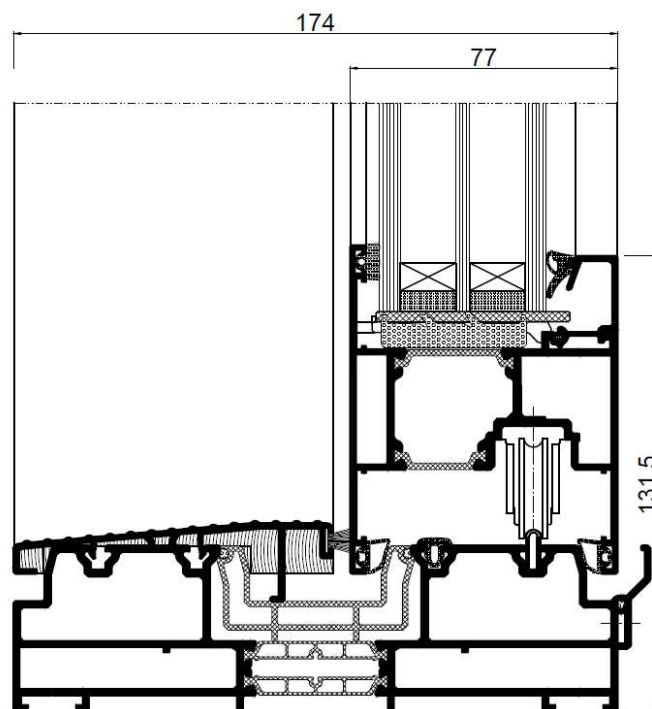

2-rail frame with regular bottom rail

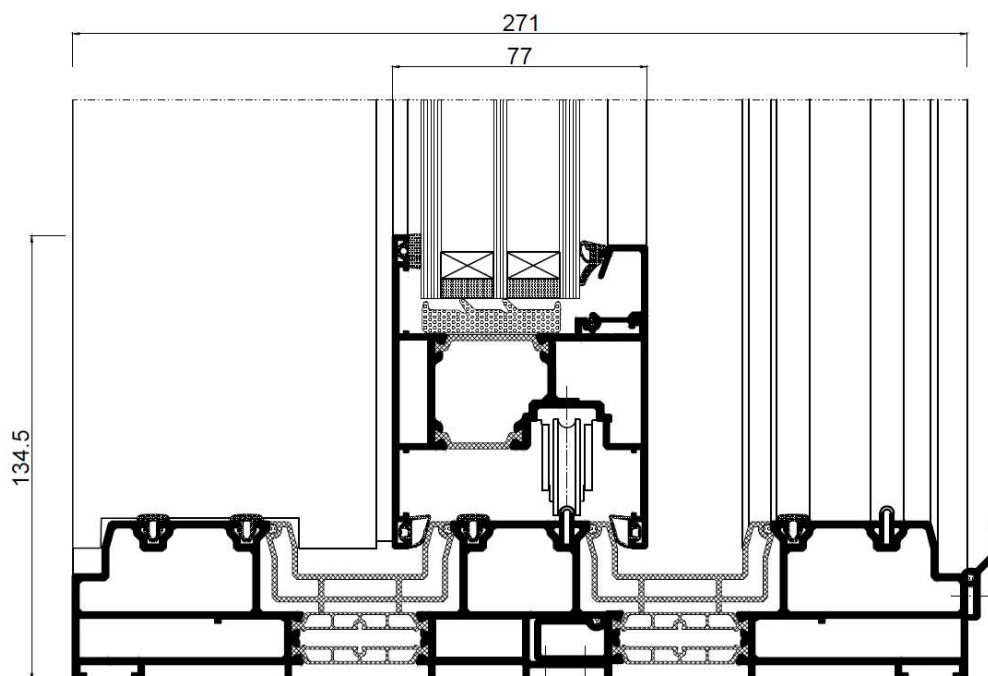

3-rail frame with regular bottom rail

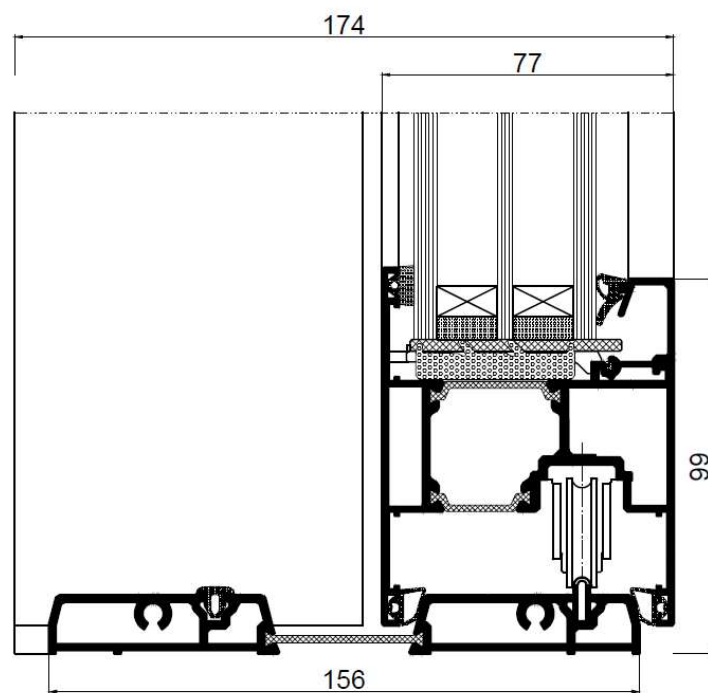

Flat bottom rail

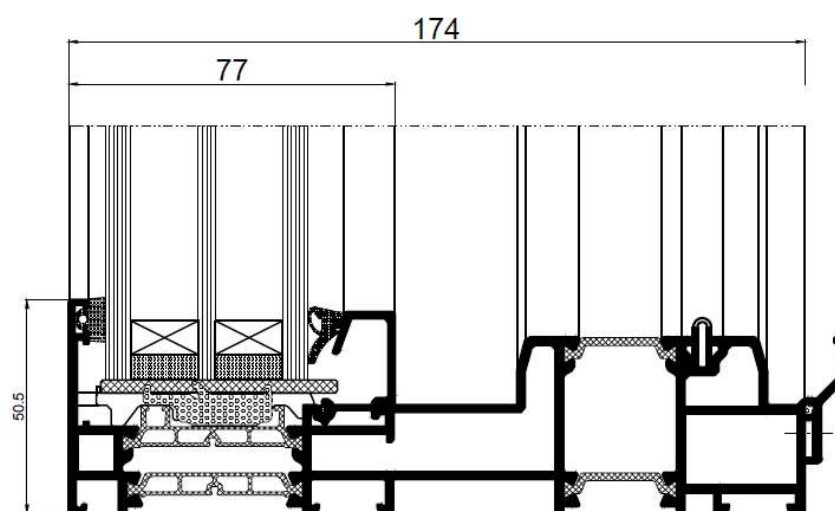

Fixed glazing in frame

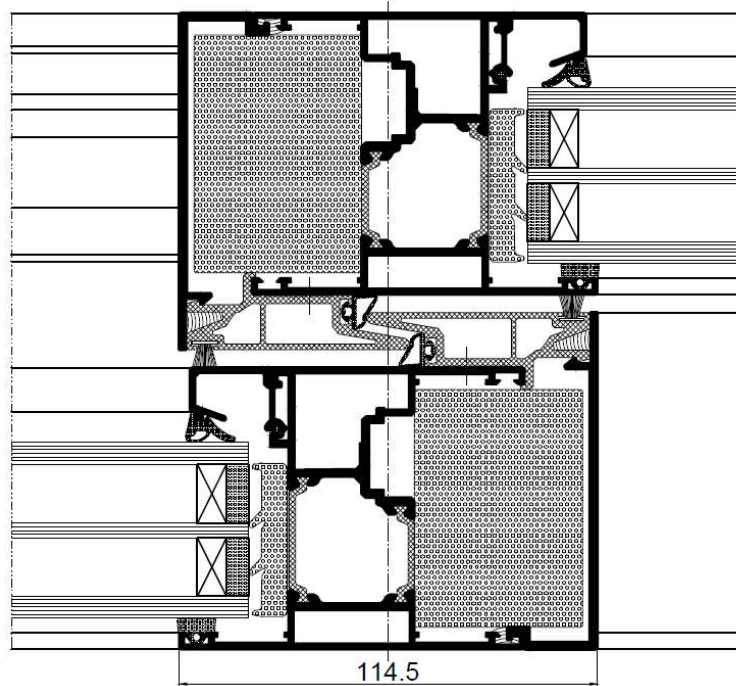

Regular mullion

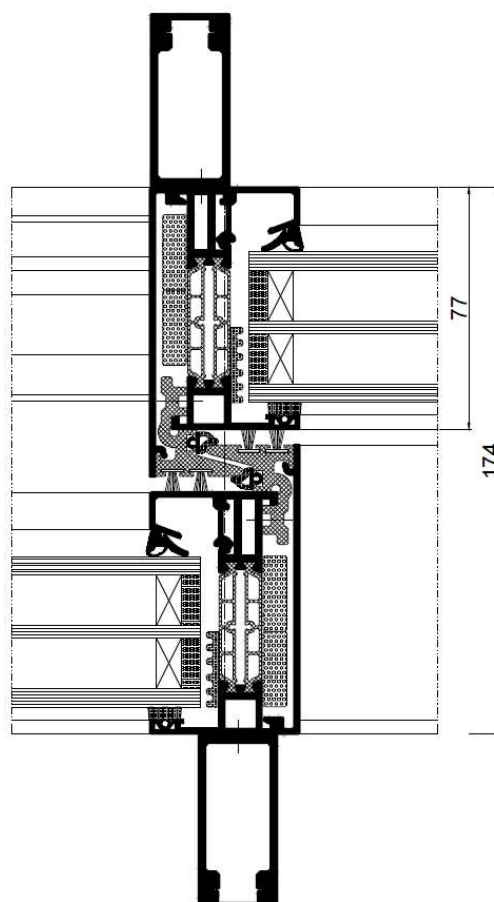

Slender mullion

## Handles

